

TCORX
FITNESS IN MOTION

INSTRUCTION



WBX50



Dansk

No.	Description	Q'ty
1	Right & left upright post	2
2	Upper upright post	2
3	Adjustable tube	2
4	Short bottom tube	2
5	Extension tube	1
6	Disc tube	2
7	Right safety hook	1
8	Left safety hook	1
9	End cap	4
10	Square inner cap	2
11	Round inner cap	2
12	Square outer cap	4
13	Release knob	4
14	Anti-slip pad	2
15	Round cushion knob	2
16	M10X20 hex bolt	14
17	M10 washer	12
18	M6 nut	2

Part list

Part drawing:

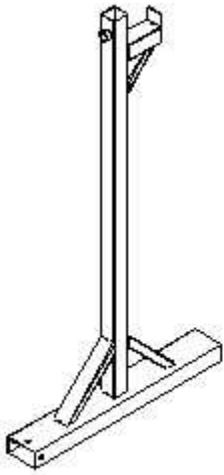

1. Right & left upright post

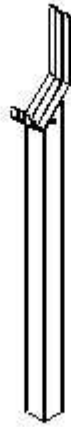

2. Upper upright post

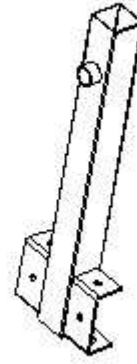

3. Adjustable tube

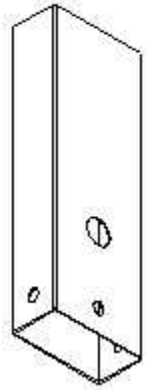

4. Short bottom tube



5. Extension tube



6. Disc tube

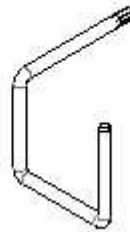

7. Right safety hook

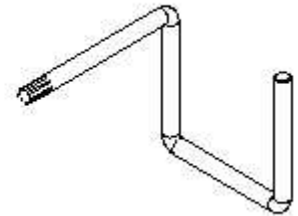

8. Left safety hook

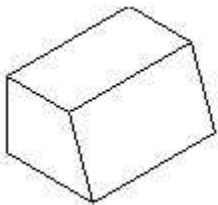

9. End cap

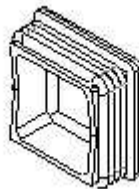

10. Square inner cap

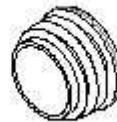

11. Round inner cap

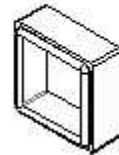

12. Square outer cap

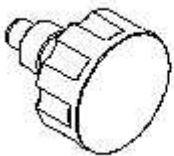

13. Release knob

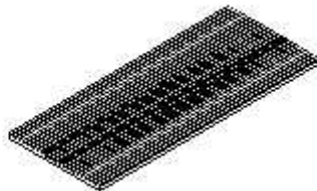

14. Anti-slip pad



15. Round cushion knob

Hardware components:

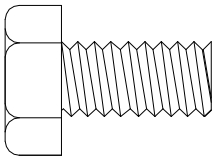

NO.16 Hex Bolt M10x20mm

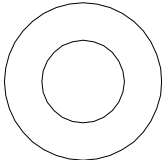

NO. 17 Washer M10



NO. 18 Nylon Nut M6

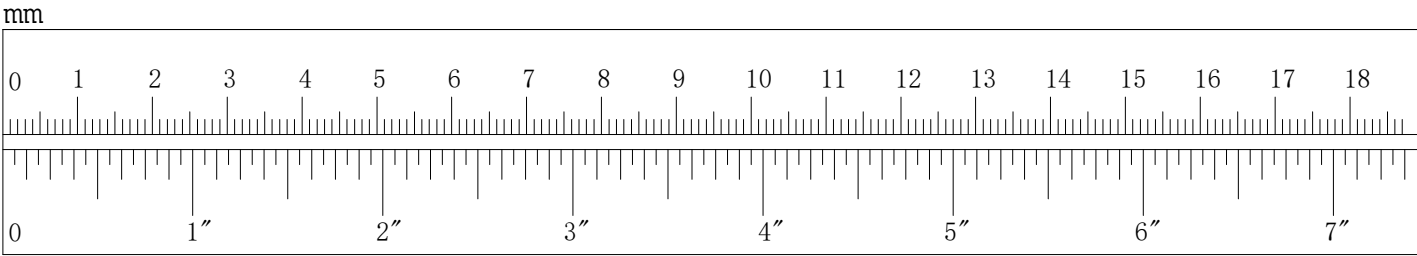

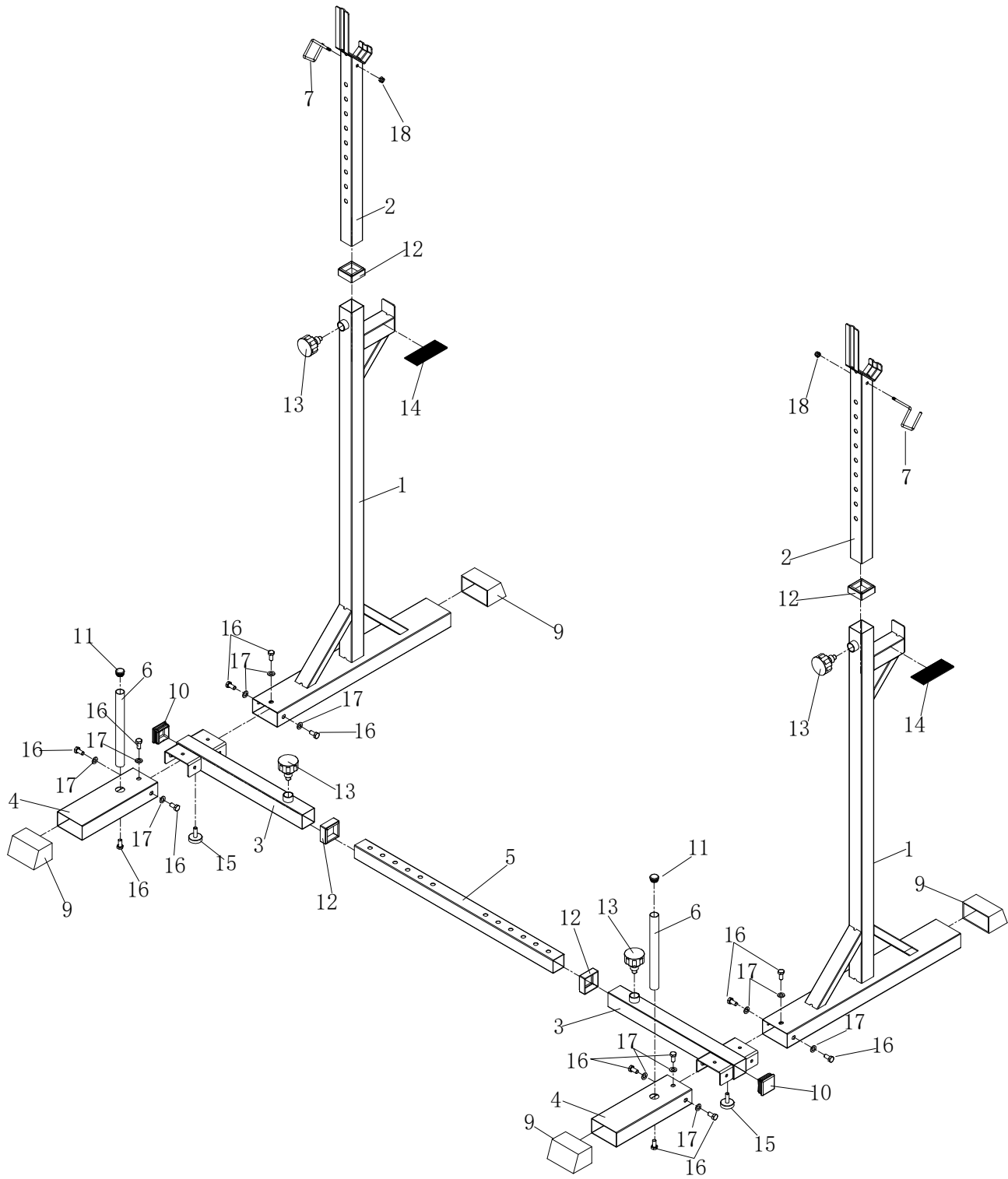

SAMLE VEJLEDNING

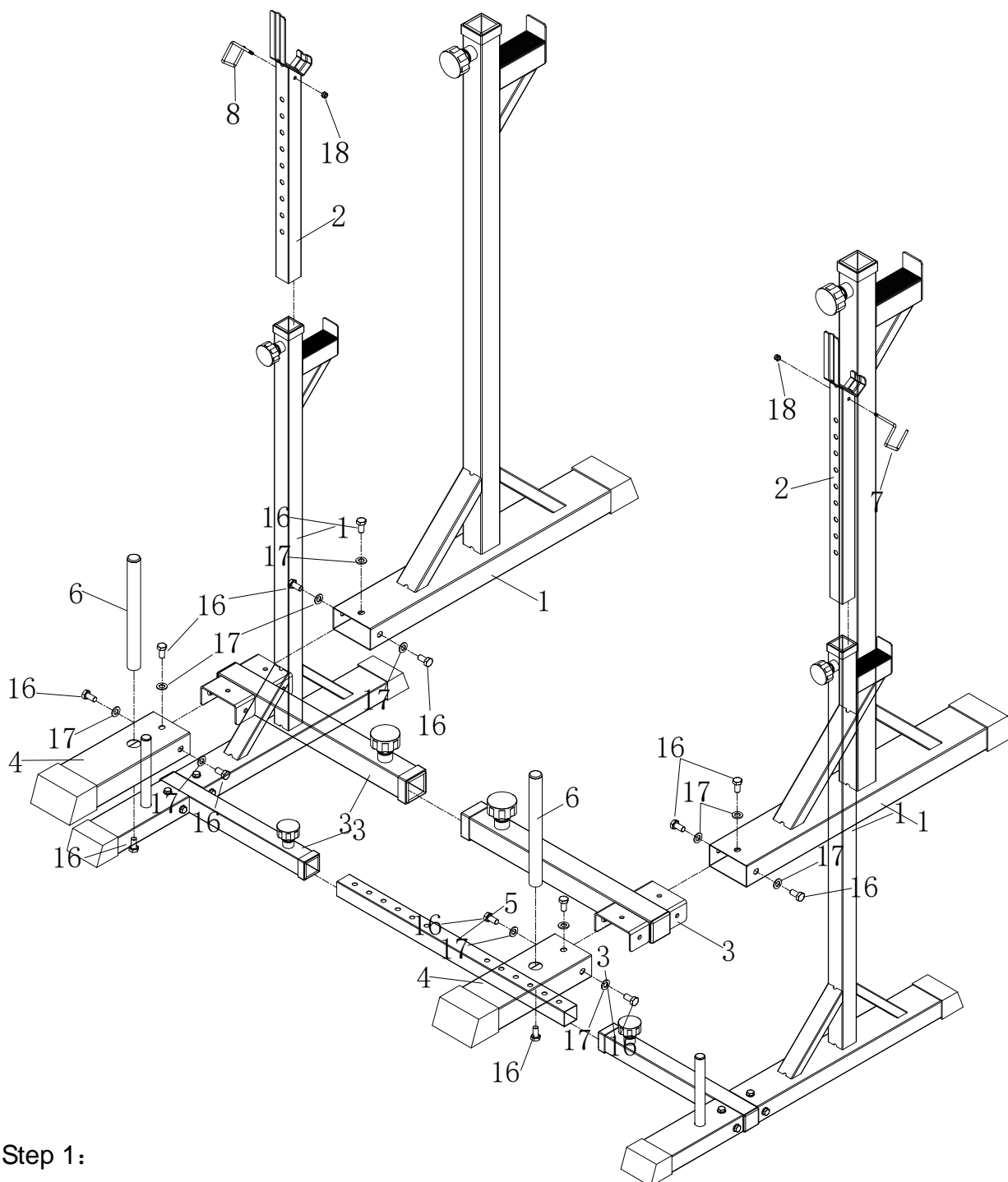

Step 1:

- a) Fastgør skiverøret (6) på det korte bundrør (4) med sekskantbolten (16).
- b) Saml det korte bundrør (4) til U-formbeslaget på det justerbare rør (3) og fast med sekskantbolt (16) og skive (17).
- c) Saml højre og venstre lodrette stolper (1) til U-formbøjlen i det justerbare rør (3) og fastgjort med sekskantbolt (16) og skive (17).

Step 2:

- a) Insert the extension tube (5) to the middle of two adjustable tubes (3), then adjust the position through the holes.
- b) Insert the upper upright post (2) to the right & left upright posts (1), and fix the right safety hook (7) and left safety hook (8) to the upper upright post (2) by nut (18).



GARLANDO SPA
Via Regione Piemonte, 32 - Zona Industriale D1
15068 - Pozzolo Formigaro (AL) - Italy
www.toorx.it - info@toorx.it